

Rest House Guide Map

3F

Portion of the roof (concrete slab) that collapsed in the atomic blast wind

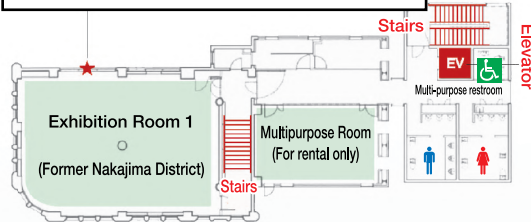

2F

Ceiling beam damaged by the atomic blast wind

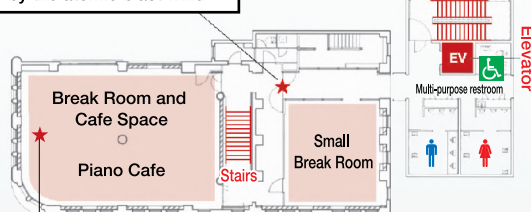

Hibaku (atomic-bombed) piano

1F

Ceiling blackened by a fire caused by the atomic bombing



B1F

Please use the elevator or the stairwell beside it to get to the basement floor.

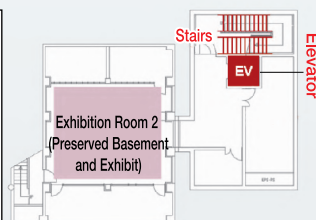

Rental Spaces

The following spaces can be rented out for private use:

- Multipurpose Room (3F, approx. 50㎡) (Please note that the capacity for each space is about 20-30 people)
- Small Break Room (2F, approx. 53㎡)

◆ For details regarding rental spaces (pricing, conditions, application process, etc.), please see the Rest House official website (Japanese).

Building History

The Rest House, designed by architect Masuda Kiyoshi, was built in 1929 as the Taisho-ya Kimono Shop. On August 6, 1945, the atomic bomb burst in mid-air about 170 meters northeast of the building, burning it out completely. However, as it was built of reinforced concrete, the shape of the building remained. Repairs began early in the year after the bombing, and the building was functional once again. Then, in 1957, it was bought by the City of Hiroshima to be used as headquarters for recovery efforts for the eastern part of the city. The building was renovated to become the Rest House in 1982, and beginning in 2018, it once again underwent renovation to become the Rest House that you see today.



Directions via Public Transport: About 20 minutes from JR Hiroshima Station
Via Streetcar (Hiroshima Dentetsu)

- Get off at Genbaku Dome-mae on the streetcars bound for Miyajima-guchi (No. 2) or Eba (No. 6)
- Get off at Hondori on the streetcar bound for Hiroshima Port (Ujina) via Kamiya-cho Line (No. 1)
- Via Bus
- Get off at Peace Memorial Park on the Hiroshima Bus headed for Yoshijima from the South Exit of JR Hiroshima Station (Platform 4, Bus Number 24)
- Get off at Genbaku Dome-mae or Peace Memorial Park on the Meipuru-pu Inner City Sightseeing Loop Bus from the Shinkansen Exit of JR Hiroshima Station

REST HOUSE

Hiroshima Peace Memorial Park

1-1 Nakajima-cho, Naka-ku, Hiroshima 730-0811 (Inside Hiroshima Peace Memorial Park)
Tourism Information: 082-247-6738 // Administration Office: 082-546-9133

Hours: Mar-Nov (excluding Aug): 8:30 am-6 pm
Dec-Feb: 8:30 am-5 pm
Aug (excluding Aug 5-6): 8:30 am-7 pm
Aug 5: 8:30 am-8 pm
Aug 6: 7:30 am-8 pm



Hours for the Rest House Gift Shop and Piano Cafe differ.
For more details, please see our website

<https://hiroshima-resthouse.com>

Instagram



REST HOUSE

Hiroshima Peace Memorial Park

Inheriting the Memories of the Past,
Conveying Them to the Future



REST HOUSE

Hiroshima Peace Memorial Park

The Rest House is the only building remaining in Peace Memorial Park that showcases what the former Nakajima District was like before the atomic bombing. Upholding its historical characteristics, the building was renovated to preserve and utilize it as a place that conveys the realities of the bombing and shares the will for peace, as well as to improve the quality of hospitality offered to our guests in Peace Memorial Park. As a building that survived the atomic bombing, the Rest House carries an important legacy. In July 2020, it was reopened with a renovated interior and facade that recreates the way it looked at the time of construction.



Bringing Life in the Former Nakajima District to the Present

Conveying History and Culture (Exhibit Room and Multipurpose Room)



The exhibit room is home to four exhibits about the former Nakajima District. You can also find a large-scale diorama in the center of the room, as well as photos and more that offer a glimpse into the progression of the Nakajima District and the history of the Rest House. You can see a portion of the roof (concrete slab) that collapsed in the atomic blast wind in the ceiling of Exhibit Room 1.

A Place to Rest

Bringing People Together
(Break Room and Cafe Space)



Piano Cafe Break Room and Cafe Space

Snacks and drinks are available in the cafe, including original blend coffee and desserts. This area also displays a piano that survived the atomic bombing.

Regional Connections

A Gateway to Cities and Towns (Tourism Information Counter and Specialty Product Gift Shop)



- Our tourism information counter offers a variety of tourism experiences, including peace-related tours.
- Find Hiroshima specialty products and souvenirs in the Rest House Gift Shop.
- In the hall ceiling, you can see a portion of the ceiling that was blackened by a fire caused by the atomic bombing.

In a Basement 170 Meters from the Hypocenter

Conveying History and Culture (Exhibit Room)



The basement room features an account by Eizō Nomura, the sole survivor of the bombing inside of this building, as well as illustrations that depict the bombing, photos right after the bombing, and more.



Hiroshima Free Wi-Fi is available on every floor

Restrooms are located on 1F, 2F, and 3F

The Rest House is a barrier-free facility.

3D Digital Experience in Peace Memorial Park

An interactive digital map of the park perfect for tourism and peace education!



Tours (Fees Apply) Rest House Departure Tour

Peace Memorial Park Tour and VR Experience

Friendly local tour guides take you around Peace Memorial Park. Using the latest VR technology, this tour allows you to deepen your understanding of Hiroshima.



Sokoiko! Peace Cycling Tour

This guided tour focuses on Hiroshima from WWII to post-war reconstruction by taking you to different sites in Hiroshima City. Experience the story of Hiroshima's incredible recovery and reconstruction!



Hiroshima Peace Memorial Park

Cruise and Cafe Coupons

Use these coupons at select facilities in the Motoyasu Bridge area near the Atomic Bomb Dome for discounts on select products and services. You can also use these coupons for other menu items and services!
Cruise and Cafe Coupon Set: 1,500 yen (two 500-yen coupons, five 100-yen coupons)

